

Exhibit P-127

OSLER
PAMPHLET
REPRINT COLL.



Your Pocket Guide to the

NEW

ROYAL
VICTORIA

HOSPITAL

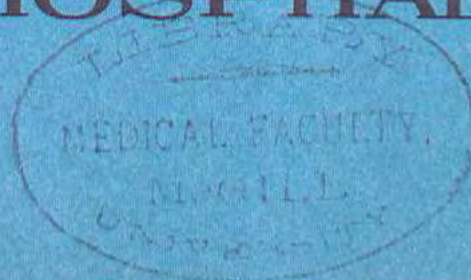

DEC 20 1955

Your pocket guide to the new Royal Victoria
Hospital
HEW 72553



Gift of:

contents

	Page
About the booklet.....	1
About the Hospital....	2
Alphabetical Key.....	3-7
Aerial View.....	8
Isometric Drawing....	9
How to Get There.....	10
Floor Plans.....	11-28

about this booklet...

This booklet has been prepared to provide you with a convenient pocket guide to the Royal Victoria Hospital as it appears during its extensive programme of expansion and reconstruction.

The booklet includes an aerial view of the Hospital and an isometric drawing of the buildings, identified by numbers. Simplified plans are shown for all levels, or floors, with numbered pointers indicating the location of specific departments and areas. The key to the numbers is listed below each floor plan. In all identification of departments or areas, three typelaces are used. **Dark Face** type indicates permanent location. Light face type indicates temporary location only. *Italics* indicate proposed future location.

To quickly locate a department or area, use the Alphabetical Key. After the name of the department is the page number on which you will find the floor plan; also the number indicating the department or area's exact location on that floor.

about the hospital...

Famous as a centre of patient care, education and clinical research, the Royal Victoria Hospital is one of Canada's largest public general hospitals, with 850 beds and 115 bassinets.

The hospital was founded in 1887 by Sir George Stephen, later Lord Mount Stephen, and Sir Donald Smith, later Lord Strathcona, as a memorial to the fiftieth anniversary of Queen Victoria's reign. The charter for the hospital's incorporation was granted by "Her Majesty by and with the advice of the Senate and the House of Commons of Canada" on June 23, 1887.

Patterned after the Royal Infirmary of Edinburgh, the hospital's original buildings were formally opened on December 2, 1893, by the Governor-General of Canada, the Earl of Aberdeen. The first seven patients were admitted on January 2, 1894.

In addition to the Main Building, which was the original unit, the hospital's buildings include the Ross Memorial Pavilion, (built in 1916), the Women's Pavilion (1926), the Allan Memorial Institute of Psychiatry, (opened in 1944 and a 50-bed wing added in 1953), and the New Wing (completed in 1955). Each year at the hospital, 19,000 patients are admitted, 3,500 babies are born, 11,500 surgical operations are performed, and outpatient consultations in 33 medical, surgical and specialty clinics total 75,000.

Alphabetical Key

	Page	(Location Number)
A		
Administration Offices.....	13	(13)
Admitting, Temporary.....	13	(14)
Admitting.....	12	(8)
Anaesthesia Dept't.....	17	(59)
Audiometric Laboratory.....	17	(55)
Allan Memorial Institute		
Entrance.....	26	(101)
Admitting.....	26	(102)
Business Office.....	27	(111)
Day Hospital.....	26	(104)
Dietary.....	26	(105)
E.E.G. Laboratory.....	28	(118)
Occupational Therapy.....	26	(106)
Doctors' Offices.....	27	(113), 28 (117)
Psychology Dept't.....	26	(104)
Reference Library.....	26	(108)
Research Laboratories.....	28	(115)
Seminar Rooms.....	26	(109)
Social Service.....	28	(114)
Therapy Unit.....	26	(103)
Wards.....	27	(110, 111, 112), (116)
B		
Bessborough Laboratory.....	21	(87)
Business Office.....	13	(12)
C		
Cafeteria No. 1.....	15	(36)
Cafeteria No. 2.....	17	(53)
Cafeteria No. 2, Temporary.....	14	(24)
Central Sterile Supply.....	14	(22)
Coffee Shop.....	15	(35)
Conference Rooms.....	15	(38)

D Diagnostic Clinics.....	14 (17)
Dietary Offices.....	15 (37)
Dietary Women's Pavilion.....	20 (79)
Dietetics, Director.....	15 (41)
Doctors' Lounge.....	13 (15)
Ward D.....	15 (32)

E Endocrine Laboratory.....	14 (18)
Entrance, Main.....	13 (10)
Entrance, Emergency.....	11 (1)
Entrance, Temporary O.P.D.....	15 (34)
Entrance, O.P.D.....	11 (4)
Entrance, Ross Memorial.....	20 (77)
Entrance, Women's Pavilion.....	21 (85)
Entrance, Women's Pavilion University Street.....	19 (69)
Entrance, Allan Memorial.....	26 (101)
Emergency Operating Room.....	11 (2)
Emergency Ward.....	11 (3)
Ward E.....	15 (33)

F Formula Room.....	20 (80)
Ward F.....	16 (51)

G General Stores.....	14 (21)
Gift Shop.....	13 (14)
Gynaecology.....	24 (98), 25 (100)

H Haematology Laboratory.....	14 (24)
--------------------------------------	---------

I Infirmary, Nurses'.....	18 (64)
Internes' Residence.....	20 (75)
Investigative Ward.....	16 (47)

J Ward J.....	18 (65)
----------------------	---------

K Kitchen, Main.....	17 (52)
-----------------------------	---------

L Lecture Room, Women's Pavilion....	20 (82)
---	---------

M Medicine, Dep't Offices.....	14 (23), 16 (46)
Medical Clinics.....	14 (19)
Medical Library.....	15 (29)
Medical Wards.....	14 (20), 18 (64,65)
	19 (70)

N Nursing, Dep't Offices.....	15 (30, 31)
Nurses' Infirmary.....	18 (64)
Nurseries.....	22 (91)

	Page	(Location Number)
O		
Obstetrics, Public.....	22	(91)
Obstetrics, Semi-Private, Private.....	23	(94), 24 (98)
Operating Theatres, Main.....	17	(56)
Operating Theatres, Ross Memorial.....	24	(96)
Operating Theatres, Women's Pavilion.....	25	(100)
Ophthalmology Ward.....	18	(63)
Orthopaedic Ward.....	19	(66)
Otolaryngology Ward.....	19	(71)
Ward O.....	18	(64)
Out Patient Department		
O.P.D. Temporary Entrance.....	15	(34)
O.P.D. Temporary Area.....	15	(33)
O.P.D. Entrance.....	11	(4)
O.P.D. Registration.....	12	(6)
O.P.D. Central Clinic.....	12	(7)
O.P.D. Clinics.....	15	(43), 16 (51)
O.P.D. General Clinics.....	16	(49)
O.P.D. Surgical.....	11	(5)
O.P.D. Women's Pavilion.....	19	(67)
P		
Paediatrics Ward, Temporary.....	15	(44)
Paediatrics Ward.....	17	(54)
Paediatrics O.P.D.....	17	(54)
Passage to New Wing.....	13	(16)
Passage to Ross Memorial.....	15	(42), 20 (74)
Passage to Women's Pavilion.....	20	(81)
Passage to Montreal Neurological Institute.....	15	(39)
Pharmacy.....	12	(9)
Physiotherapy.....	15	(25)

	Page	(Location Number)
R		
Radiology Dep't.....	16	(50)
Record Room.....	15	(27, 28)
Recovery Room, Main.....	17	(57)
Recovery Room, Women's Pavilion.....	25	(100)
Ross Bridge.....	20	(76)
Ross Memorial Pavilion (Private Patients)		
Entrance.....	20	(77)
S		
Solarium, Sun Deck.....	22	(89)
Social Service.....	15	(26)
Surgery, Dep't. Offices.....	17	(58)
Surgical Wards.....	17	(54), 19 (70)
Surgical Wards.....	20	(72, 73),
.....	21	(83, 84)
Surgical Pathology.....	17	(60)
T		
Telephone Switchboard.....	19	(68)
Transfusion Service.....	14	(24)
U		
University Clinic.....	16	(45, 48)
Urology Dep't.....	18	(61)
Urology Ward.....	18	(62)
V		
Volunteers' Dep't.....	15	(40)
W		
Women's Pavillion		
Main Entrance.....	21	(85)
University St. Entrance.....	19	(69)
Dietary.....	20	(79)
Formula Room.....	20	(80)
Ground Floor.....	20	(78)
Lecture Room.....	20	(82)
O.P.D.....	19	(67)



Aerial View of the Royal Victoria Hospital

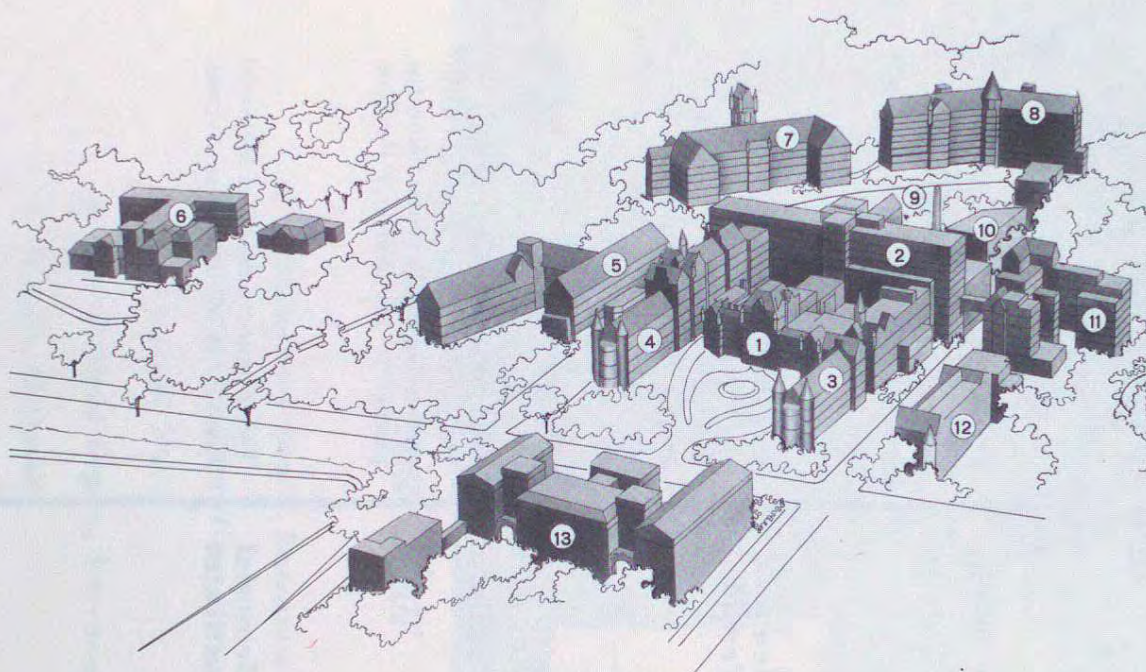

- 1. ADMINISTRATION
- 2. NEW WING
- 3. MEDICAL WING AND OUTDOOR DEPARTMENT
- 4. SURGICAL WING

- 5. NURSES' HOME
- 6. ALLAN MEMORIAL INSTITUTE
- 7. ROSS MEMORIAL PAVILION
- 8. WOMEN'S PAVILION
- 9. INTERNES' RESIDENCE

- 10. POWER HOUSE AND LAUNDRY
- 11. MONTREAL NEUROLOGICAL INSTITUTE
- 12. PATHOLOGICAL INSTITUTE
- 13. MEDICAL BUILDING, MCGILL UNIVERSITY

how to get there . . .

New Wing:

On entering the main entrance of the Royal Victoria Hospital, follow the main corridor directly in front of you.

Ross Memorial Pavilion:

On entering the new wing by the above route, take any one of the four elevators in the new wing to the 8th floor and turn left; follow the passage to the Ross Memorial Pavilion.

Women's Pavilion:

Take the same route as to the Ross Memorial Pavilion and turn right on entering the Pavilion; follow the passage to the Women's Pavilion.

Allan Memorial Institute:

The entrance to the Allan Memorial Institute is at 1025 Pine Avenue.

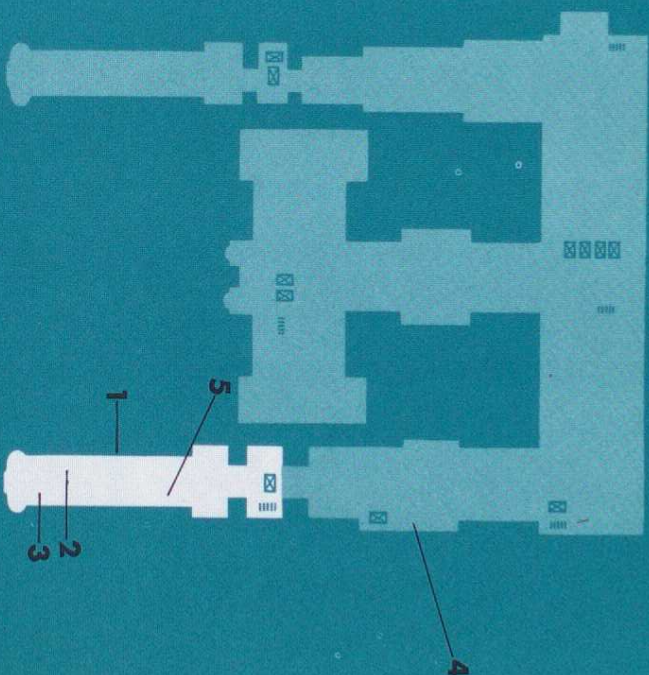

Sub-Ground Floor

1. *Emergency Dep't. Entrance*
2. *Emergency Operating Room*
3. *Emergency Ward*
4. *Out Patient Dep't., Entrance*
5. *O.P.D., Surgical*

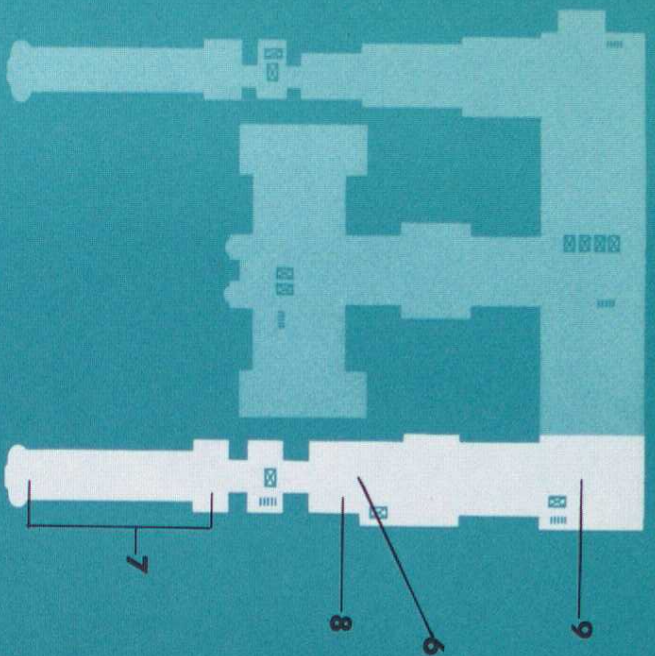

Ground Floor

- 6. O.P.D., Registration
- 7. O.P.D., Central Clinic
- 8. Admitting Dep't.
- 9. Pharmacy

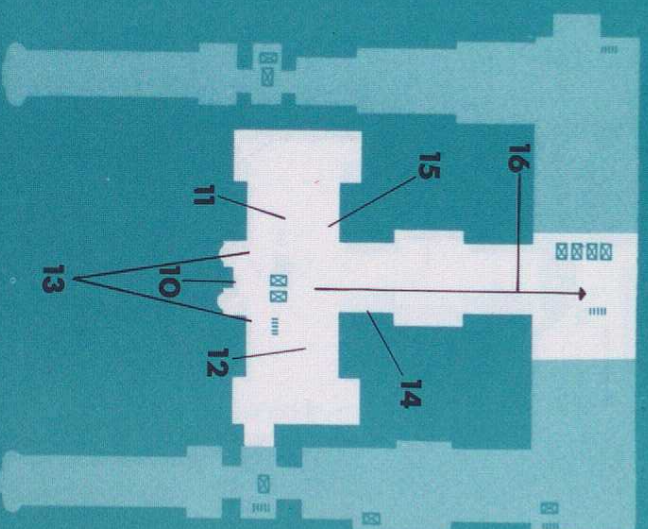

First Floor

- 10. Main Entrance
- 11. Information Centre
- 12. Business Office
- 13. Administration Offices
- 14. Admitting Office, Gift Shop
- 15. Doctors' Lounge
- 16. Passage to Other Pavilions

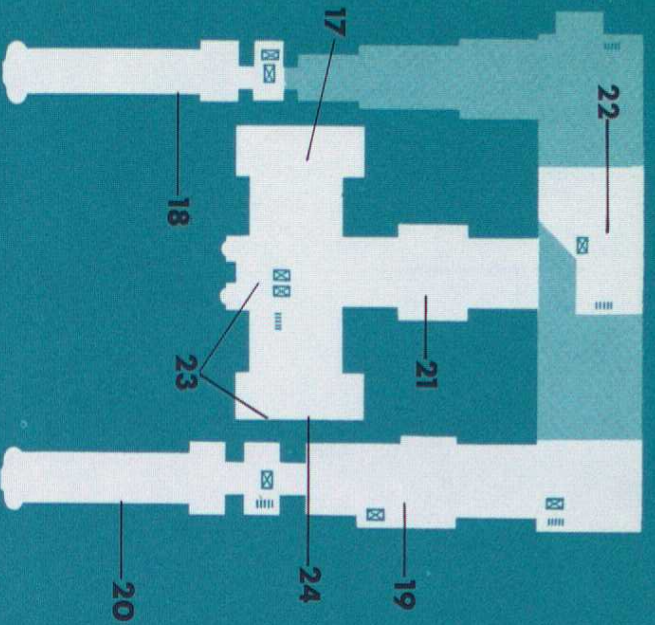

Second Floor

- 17. Diagnostic Clinics
- 18. Endocrine Laboratory
- 19. Medical Clinics
- 20. Medical Ward
- 21. General Stores
- 22. Central Sterile Supply
- 23. Dept. of Medicine, Offices
- 24. Cafeteria No. 2, Haematology Laboratory Transfusion Service

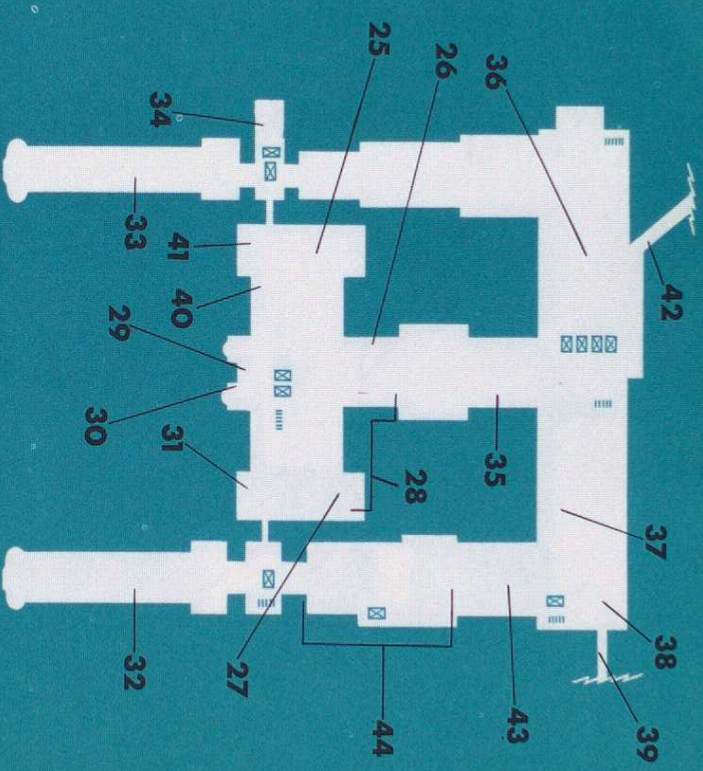

Third Floor

- 25. Physiotherapy
- 26. Social Service
- 27. Record Room
- 28. Record Room
- 29. Medical Library
- 30. Dep't. of Nursing Offices
- 31. Dep't. of Nursing Offices
- 32. Ward D
- 33. Ward E, Temporary O.P.D.
- 34. Temporary O.P.D. Entrance
- 35. Coffee Shop
- 36. Cafeteria No. 1
- 37. Dietary Offices
- 38. Conference Rooms
- 39. Passage to M.N.I.
- 40. Volunteers' Department
- 41. Director of Dietetics
- 42. Passage to Ross Pavilion
- 43. O.P.D. Clinics
- 44. Paediatrics Ward

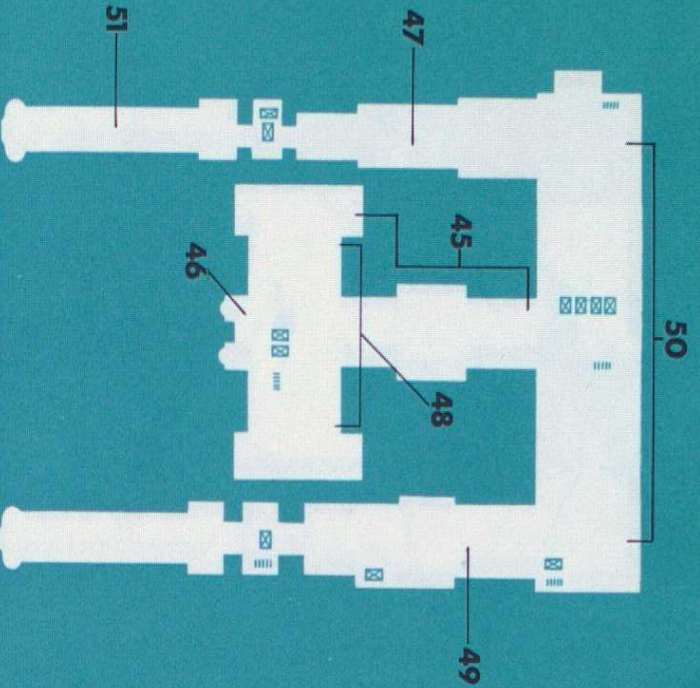

Fourth Floor

- 45. University Clinic
- 46. Dep't. of Medicine Offices
- 47. Investigative Ward
- 48. University Clinic
- 49. O.P.D., General Clinics
- 50. Dep't. of Radiology
- 51. Ward F, Temporary O.P.D. Clinics

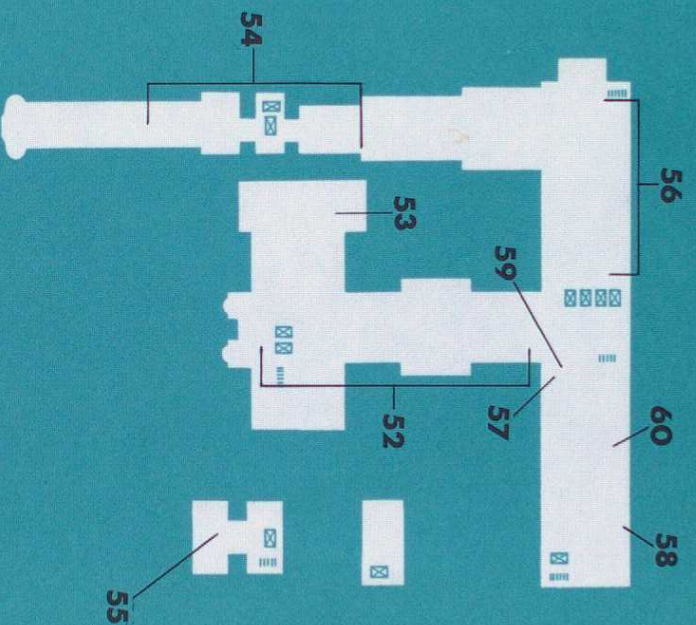

Fifth Floor

- 52. Main Kitchen
- 53. Cafeteria No. 2
- 54. Surgical Ward, Paediatrics Ward and O.P.D.
- 55. Audiometric Laboratory
- 56. Operating Theatres
- 57. Recovery Room
- 58. Dep't. of Surgery Offices
- 59. Dep't. of Anaesthesia
- 60. Surgical Pathology

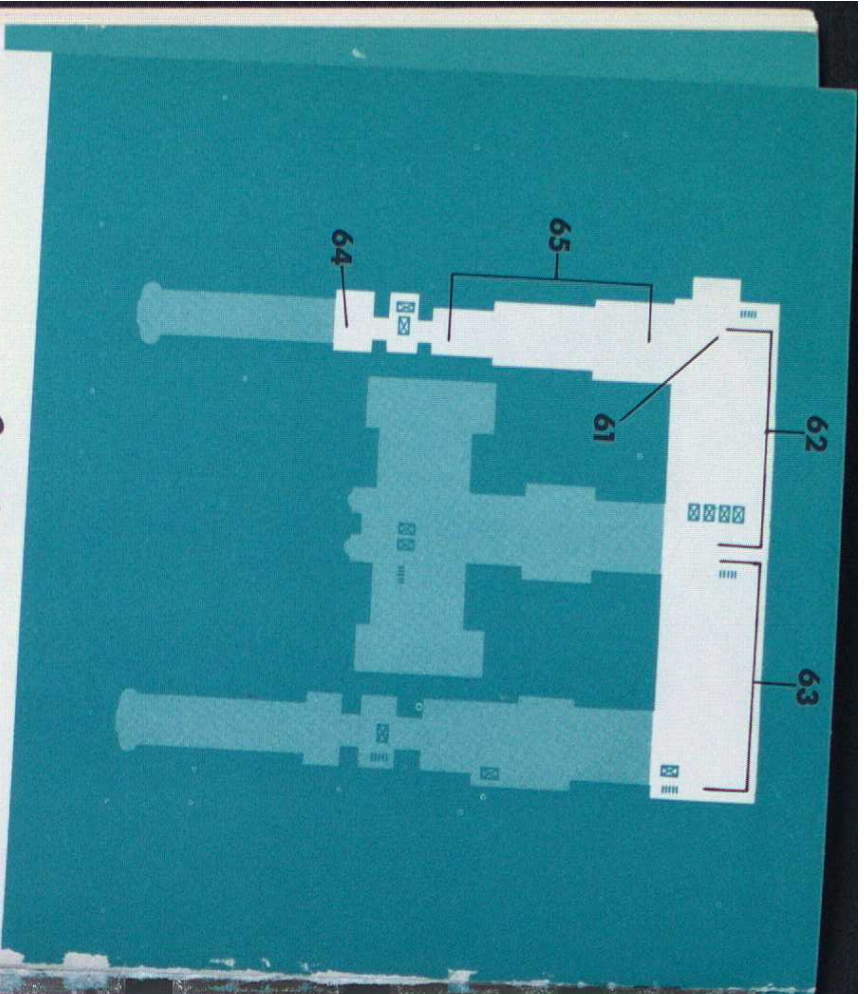

Sixth Floor

- 61. Urology Dep't.
- 62. Ward 6W (Urology)
- 63. Ward 6E (Ophthalmology)
- 64. Ward O (Medical), Nurses Infirmary
- 65. Ward J (Medical)

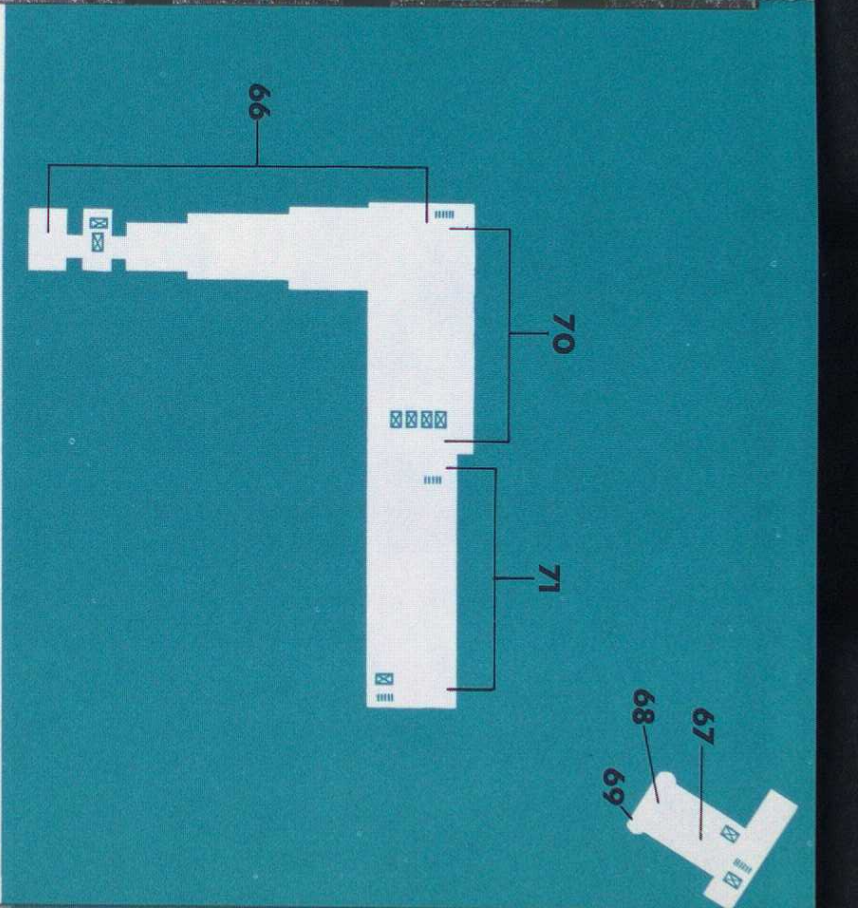

Seventh Floor

- 66. Orthopaedic Ward
- 67. O.P.D., Women's Pavilion
- 68. Telephone Switchboard
- 69. Women's Pavilion, University St. Entrance
- 70. Ward 7W (Medical), Surgical Ward
- 71. Ward 7E (Otolaryngology)

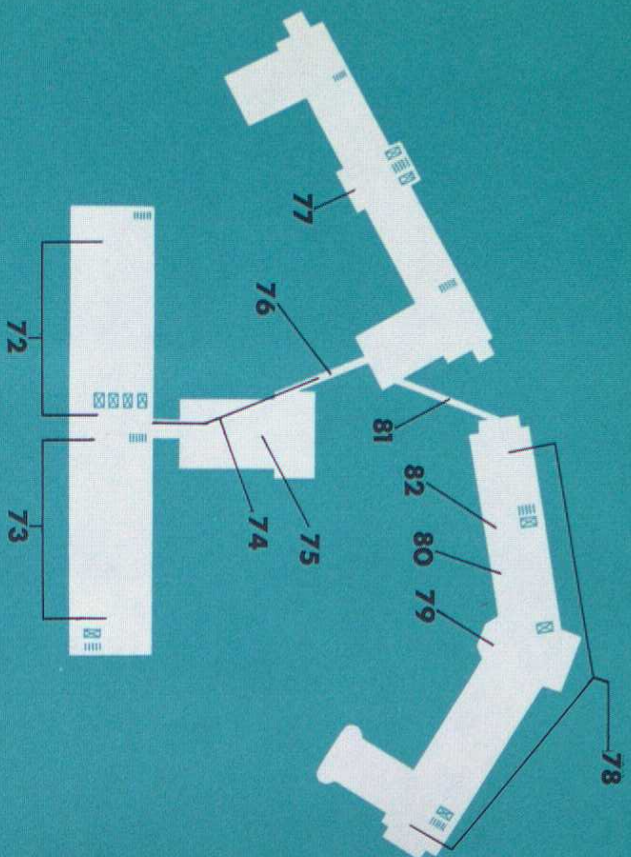

Eighth Floor

- 72. Ward 8W (Surgical)
- 73. Ward 8E (Surgical)
- 74. Passage to Ross Memorial Pavilion
- 75. Internes' Residence
- 76. Ross Bridge
- 77. Ross Memorial Pavilion, Entrance
- 78. Women's Pavilion, Ground Floor
- 79. Dietary, Women's Pavilion
- 80. Formula Room
- 81. Passage to Women's Pavilion
- 82. Lecture Room

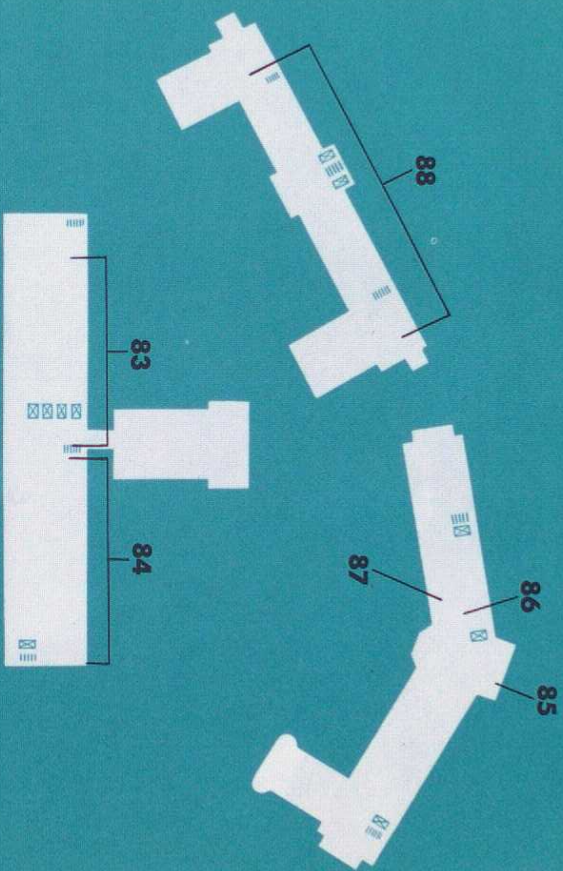

Ninth Floor

- 83. Ward 9W (Surgical)
- 84. Ward 9E (Surgical)
- 85. Women's Pavilion, Main Entrance
- 86. Professional Offices
- 87. Bessborough Laboratory
- 88. Ross Memorial Pavilion, 2nd Floor

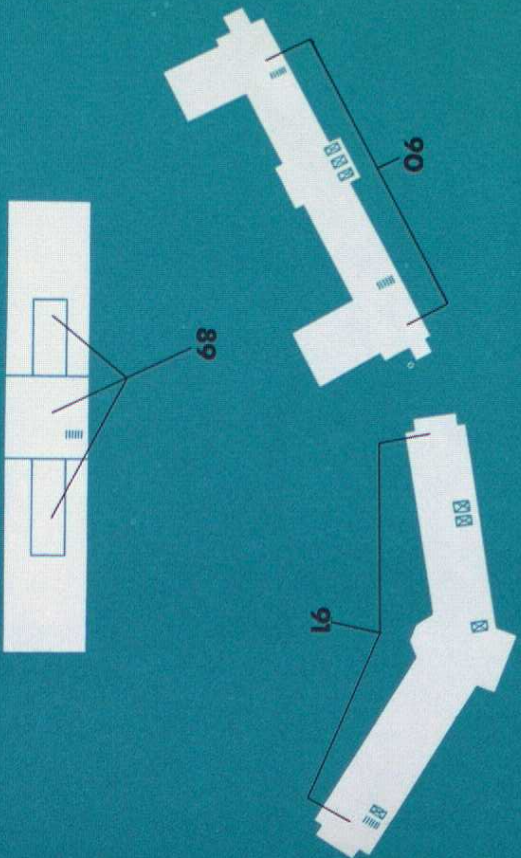

Tenth Floor

- 89. Sun Deck, Solarium
- 90. Ross Memorial Pavillion, 3rd Floor
- 91. Obstetrics, Public; Nurseries

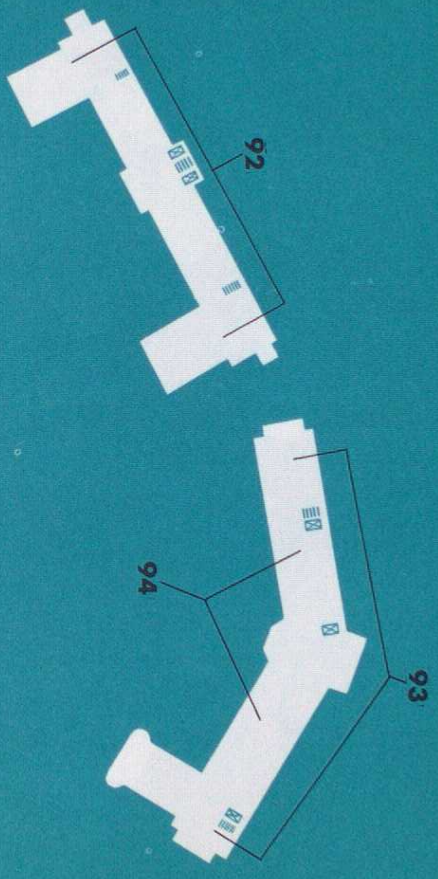

Eleventh Level

- 92. Ross Memorial Pavillion, 4th Floor
- 93. Women's Pavillion, 3rd Floor
- 94. Obstetrics, Semi-Private and Private

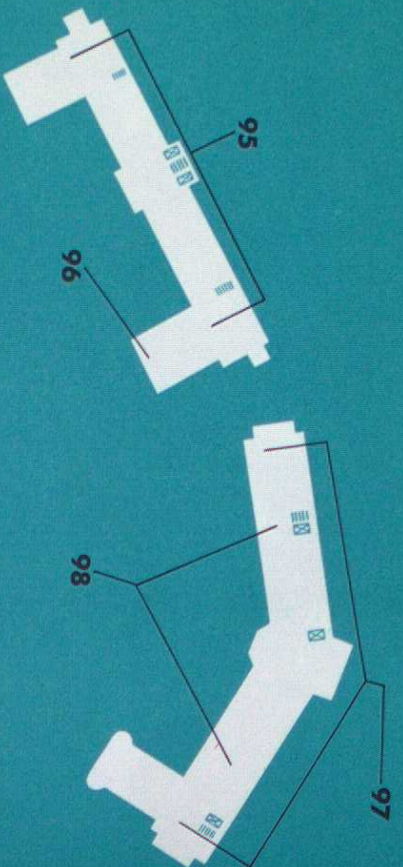

Twelfth Level

- 95. Ross Memorial Pavilion, 5th Floor
- 96. Operating Theatres
- 97. Women's Pavilion, 4th Floor
- 98. Obstetrics & Gynaecology, Semi-Private & Private



Thirteenth Level

- 99. Women's Pavilion, 5th Floor
- 100. Gynaecology, Semi-Private and Public; Operating Rooms and Recovery Room

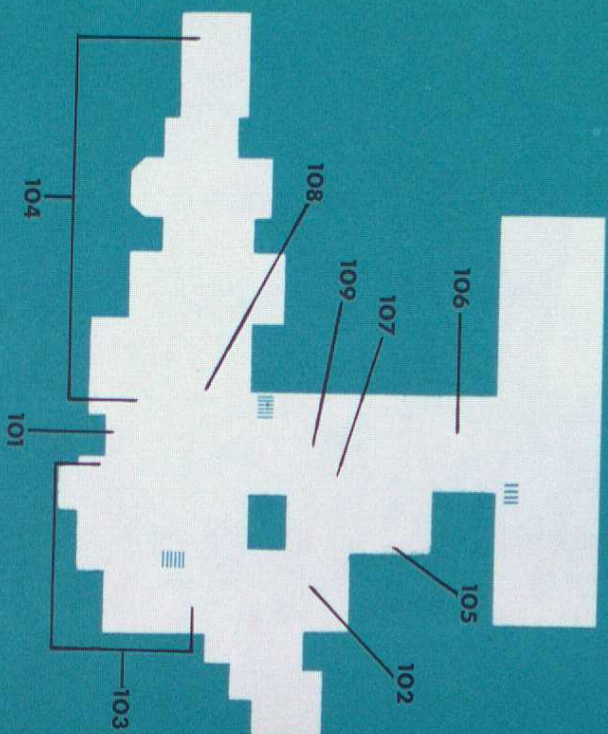

Allan Memorial Institute Ground Floor

- | | |
|--|-------------------------------|
| 101. Allan Memorial Institute, Entrance | 105. Dietary |
| 102. Admitting Dept. | 106. Occupational Therapy |
| 103. Therapy Unit. | 107. Business Office Entrance |
| 104. Day Hospital (Psychology Dept. is located below this area on the Sub-Ground Level, not shown) | 108. Reference Library |
| | 109. Seminar Rooms |

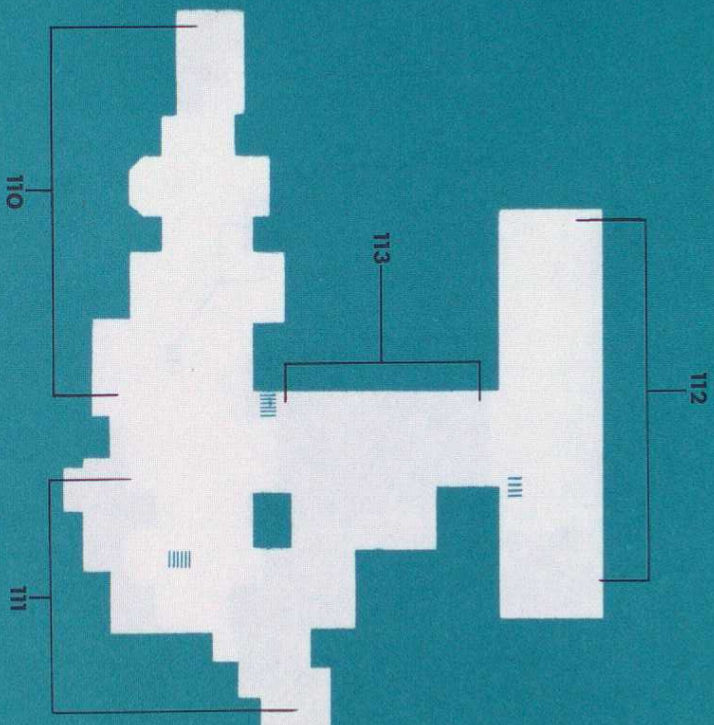

Allan Memorial Institute First Floor

- | |
|-----------------------|
| 110. Ward West 1 |
| 111. Ward East 1 |
| 112. Ward North 1 |
| 113. Doctors' Offices |

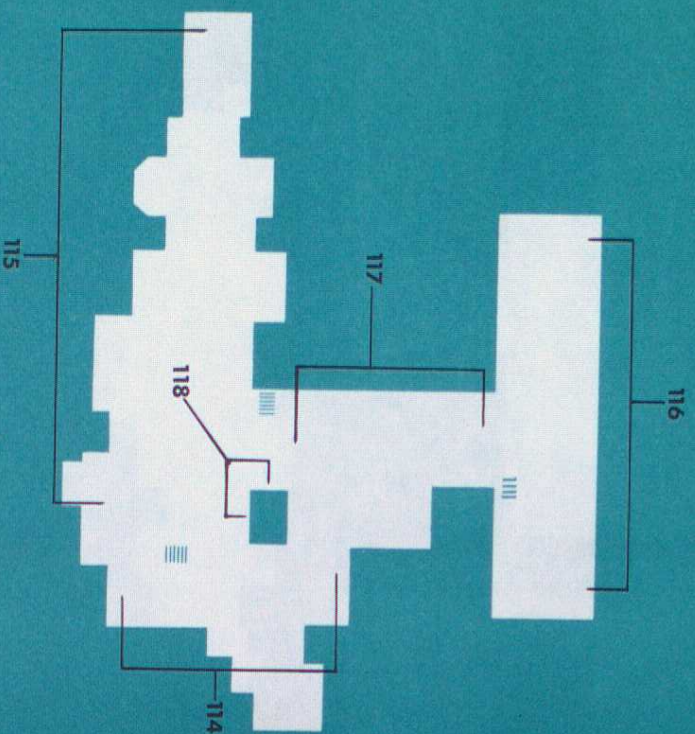

Allan Memorial Institute Second Floor

- 114. Social Service
- 115. Research Laboratories
- 116. Ward North 2
- 117. Doctors' Offices
- 118. E. E. G. Laboratory

Reprint cell Pamphlet

